

Praher Plastics Austria GmbH



PumpTech Ipari Szivattyútechnika Kft., Schwertberg

History

1971

- Company founded by Mr. Ludwig Praher

1973

- The first building is constructed at the current site in Schwertberg

1980

- First exporting activities to neighboring countries.

1985

- Production start of industrial ball valve series S4 and expansion of the company

1986

- A separate production site in Canada is established to meet rising demand

...

- Continuous Growth

2015

- Reorganisation: Praher Plastics AUSTRIA GmbH

The company today

- Family owned business
- More than 300 employees worldwide
 - Around 200 in Austria
- More than 50.000 product parts
 - 5.000 available from stock
- Turnover worldwide around 25 Mio.
 - 50 Mio. The total Praher Group
- Export rate over 50%



Partnership
With Our Customers



International
Certifications and
Accreditations



Serial and
Individual



Value Added
Propositions



Highly Qualified
Manpower

Core competences

Our product range

- High quality valve-product-lines for:
 - Water / Wastewater treatment
 - Desalination
 - Chemical Industry
 - Mining
 - ...
- High quality PVC-fittings

Taylor made manufacturing

- Development and engineering
- Own laboratory facilities for testing and certifications
- Special mold-manufacturing and maintenance
- Process engineering and automation
- Serial production
- Logistic solutions

Production

- Separated production areas for PVC, PVDF, PP etc.
- Clean-room capabilities
- All machines fully automated with handlings and robots
- Central material supply
- In-line leak-testing and quality-check program

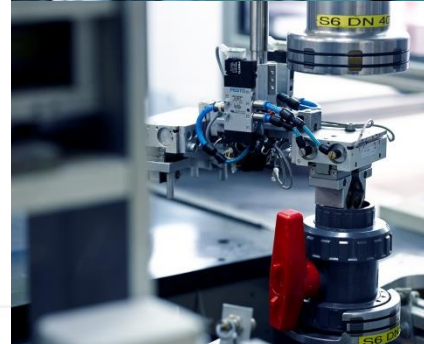
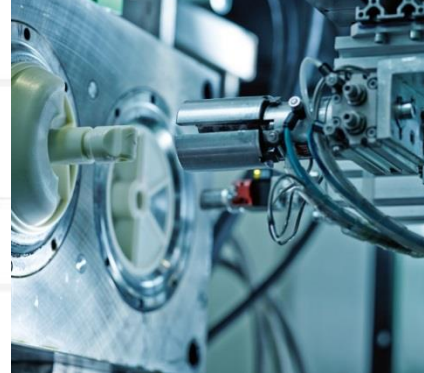



Machining- & Assembling lines



- 24h assembling
- High educated, trained and loyal specialists
- Automated and manual assembly stations for different industrial valves and products
- 100 % in-line inspection on industrial valves
- ESD assembly-line for automation products

Quality control

Precision inspection instruments and sensitive testing facilities are necessary for the production of high quality plastics. The most modern 3D measurement devices guarantee quality during all phases of the production.

ISO9001:2015 certified

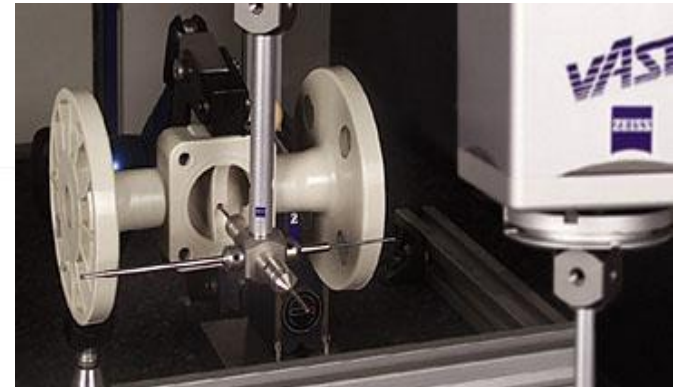

Development

- Development team with plastics-simulation capabilities
- Own in-house test-laboratory for pressure, material and HALT testing
- Own process automation team for developing and optimizing production processes



Field of applications

- Water treatment
- Wastewater treatment
- Reverse osmosis / Desalination
- Agriculture / Irrigation
- Chemical industry
- Mining
- Tank construction
- Machine building
- Semiconductor applications
- Laboratories
- Food- and drug industry
- Textile industry
- Pulp and paper plants
- Steel factories
- Etc....

Our products

Valves and fittings

PRAHER
PLASTICS



Product range

2W Ball Valve M1



M1
manual



M1 adapter
set



M1 manual
with position
feedback



M1
pneumatic



M1
electric

Product range

2W/3W Ball Valve S4

- manual
- electric
- pneumatic

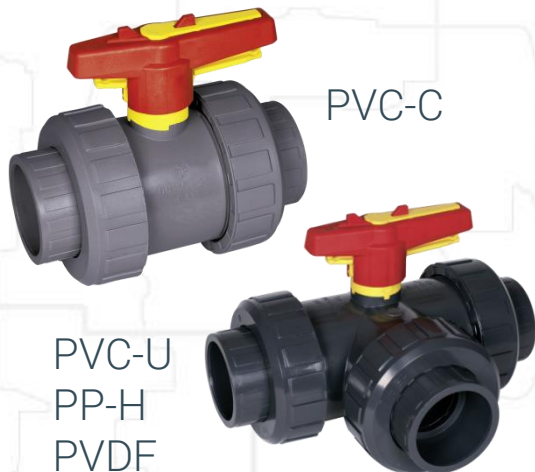

2W Ball Valve S6

- manual



Sampling Valve S4



Product range

Cone Check Valve

- Steel spring
- Spring PTFE-coated



PVC-U
PVC-C
PP-H
PVDF

Foot Valve

Cone with iron
core



PVC-U
PP-H

Line Strainer

- plastic screen
- Steel screen



PVC-U
PP-H

Aerating valve

- Floating cone



PVC-U
PP-H

2W Ball Valve M1

Material:	PVC-U / PP-H / PVDF
Seal material:	EPDM / FPM
Ball seating joint:	PTFE
Dimensions:	DN10/d16 – DN80/d110
Operating pressure:	PN16 PVC-U / PVDF PN10 PP-H
Various models:	manual manual with position feedback electric or pneumatic



2W Ball Valve M1



Integrated Fixations

In valve body integrated fixations for the adapter set



Adapter Set

Adapter set for electric, pneumatic actuation or for manual valve with position feedback. Flange pattern acc. to EN ISO 5211 – F04, F05 or F07



Position Feedback

Electical position feedback for manual ball valves with mechanic or inductive limit switches

2W Ball Valve M1



Buttress thread

For increased strenght and secure fit of the union nut

Integrated bracket

For fix point mounting. Optionally with clamping element for socket or spigot or with spacing element for flange connetion



2W Ball Valve M1

Modular design

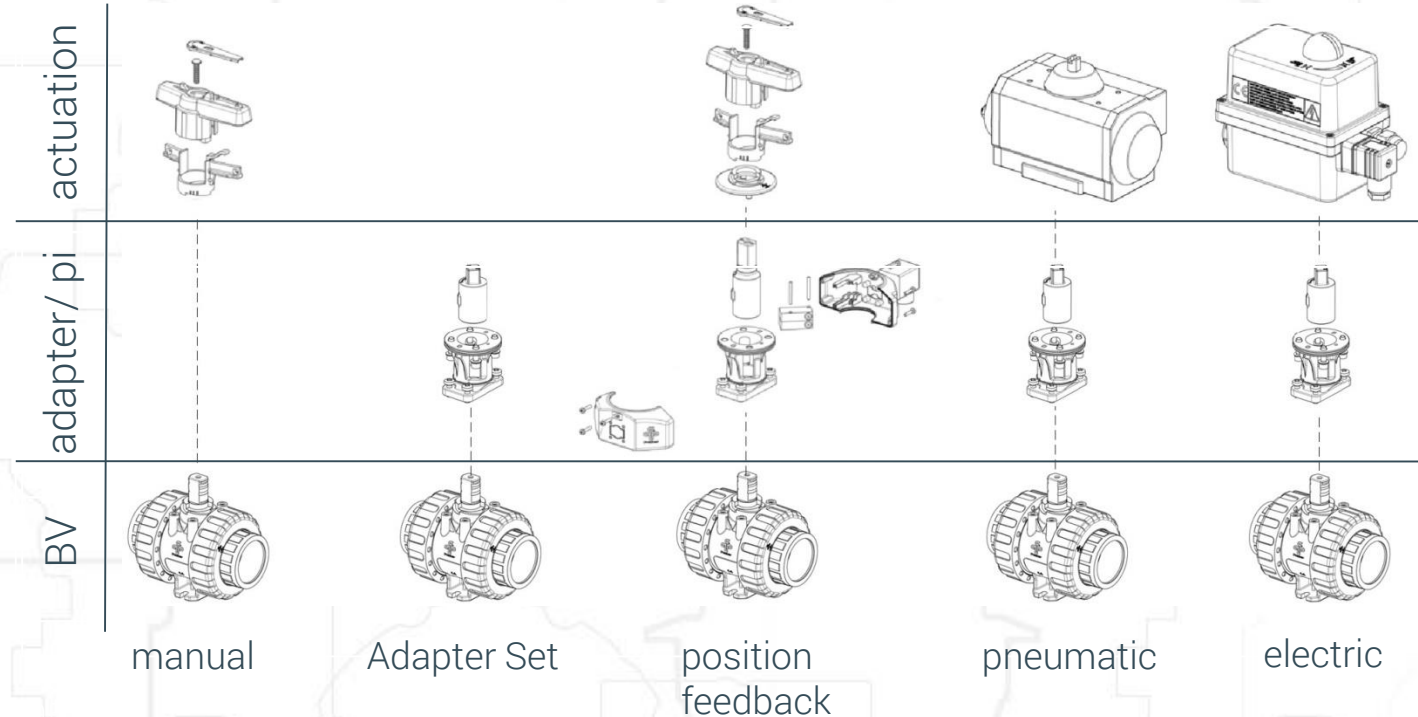

2W Ball Valve M1

Automation



Manual ball valve with mechanical or inductive limit switches for position feedback. Easily retrofittable for every M1 version.



ER Premier tested and adjusted to the M1 ball valve. As an option also ER POSI for individual adjustable positioning or ER FAILSAFE with integrated battery in case of power failure.



Single or double acting pneumatic actuator tested and adjusted to the M1 ball valve. As an option with position feedback and/or solenoid valve

2W Ball Valve M1

Safety handle with Labelling Plate

With integrated eyelet to prevent unintentional opening

A sudden closing ist possible without pulling the handle

Element

Accessories: an appropriate safety element for the handle and a cover with an eyelet for the integrated fixation



Metal-free Ball Valve

For applications in highly corrosive environments, the manual ball valve as well as the ball valve with adapter set are available with glass-fiber-reinforced plastic screws.

2W Ball Valve M1

Silicone-free

Use of silicone-free grease for the assembly of industrial valves series:

M1	ball valve
S4	ball valve, sampling valve, cone check, foot and aerating valve, line strainer
K4 / K6	wafer check valve
T4	diaphragm valve

- high functionality combined with a long service life
- reduce friction and abrasion of static and dynamic sealing elements
- increases the lifetime of the complete valve
- Silicone-free grease suitable for drinking water applications

2W Ball Valve M1

Connector types:



solvent socket metric
PVC-U



solvent spigot metric
PVC-U



threaded socket BSP, NPT
PVC-U, PP-H, PVDF



fusion socket
PP-H, PVDF, PE100



fusion spigot
PP-H, PVDF, PE100



backing flange
PVC-U, PP-GFK



fix flange
PVC-U

all interchangeable for
M1, S4 und S6 series

2W Ball Valve S6

Material:	PVC-U
Sealing material:	EPDM / FPM
Ball seating joint:	PTFE visible by red handle
	PE visible by orange handle
Dimension:	DN10 d16 – DN80 d110
Operating pressure:	PN16



2W Ball Valve M1 / S6

Difference M1: S6

- only PVC-U
- S6 without safety handle and labeling plate
- S6 without integrated bracket
- limited possibility to automation

Similarities M1 : S6

- inner structure of ball valve
- Extension for handle

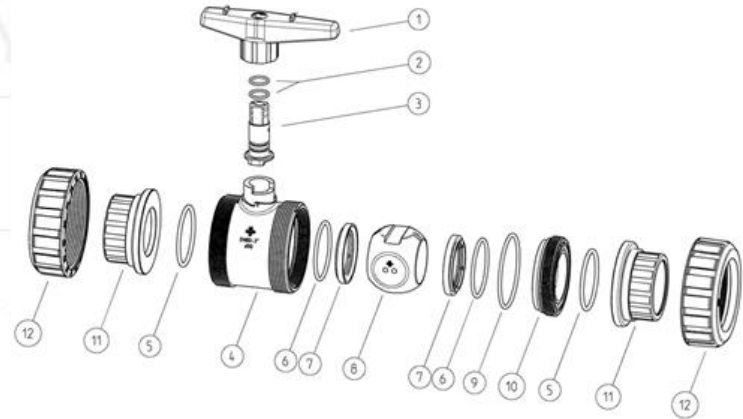

2W Ball Valve M1 / S6



Difference of EO510 and Valpes

EO
Series



M1



S6



S4

	EO510	Valpes
Series	2W M1, 2W S6, 3W S4	2W M1, 3W S4
Dimensions Pressure	2W M1 d16 – d32 PN16 2W S6 d40 – d63 PN3 3W S4 d16 – d32 10 bar 3W S4 d40 – d63 3 bar	M1 d16 – d110 PN16/10 S4 d16 – d63 PN16/10
Material	M1 S4 PVC-U, PP-H, PVDF S6 only PVC-U	PVC-U, PP-H, PVDF
Torque	10 Nm	20 Nm, 35 Nm

2W Ball Valve M1 / S6

Difference of EO510 and Valpes

	EO510	Valpes
Types	EO510 Standard	ER Premier Standard ER PLUS POSI ER PLUS Failsafe ER PLUS GF3 / GF4 → 3W BV
Voltage	Industrie 12 V AC 12- 24 V DC	ER PREMIER 90 - 240V (90 – 350V DC) 24V (24V DC) ER PLUS 90 - 240V (90 – 350V DC) 15 – 30 V (24 – 48V DC)

3W Ball Valve S4

Material:	PVC-U / PP-H / PVDF
Seal material:	EPDM / FPM
Ball seating joint:	PTFE
Dimension:	DN10/d16 – DN50/d63
Operating Pressure:	PN16 PVC-U / PVDF PN10 PP
Ball:	T- or L-Bore



3W Ball Valve S4

Manual:

- Manual T- or L-ball
- Manual T-ball 90° oder 180° limited
- Electric T- or L-ball
15- 30 VAC and 90-240 VAC
- Pneumatic T- or L-ball
spring return normally open or close
double acting
 - Accessories position feedback and / or solenoid valve



3W KH limited



3W electric

Cone Check Valve S4

Material:	PVC-U / PVC-C / PP-H / PVDF
Sealing material:	EPDM / FPM
Dimension:	DN10 d16 – DN80 d110
Operating pressure:	PN16 / PN6 PVC-U / PVDF PN10 / PN6 PP-H
Spring:	Steel spring 1.4401 PTFE coated
Opening pressure:	0,06 bar

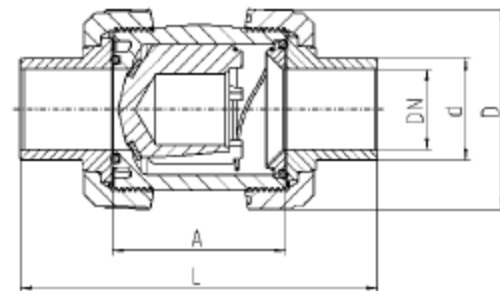

Line Strainer S4

Material:	PVC-U / PP-H
Sealing material:	EPDM / FPM
Dimension:	DN10 d16 – DN80 d110
Operating pressure:	PN16 / PN6 PVC-U PN10 / PN6 PP-H
Cone:	floating cone
PP-Screen:	1,8 mm
Steel Screen:	0,5 mm / 0,75 mm / 1 mm



Foot Valve S4

Material:	PVC-U / PP-H
Sealing material:	EPDM / FPM
Dimension:	DN10 d16 – DN80 d110
Operating pressure:	PN16 / PN6 PVC-U PN10 / PN6 PP-H
Cone:	with iron core
Opening pressure:	0,025 bar



Strainer in PP

Aerating Valve S4

Material:	PVC-U / PP-H
Sealing material:	EPDM / FPM
Dimension:	DN10 d16 – DN80 d110
Operating pressure:	PN16 / PN6 PVC-U PN10 / PN6 PP-H
Cone:	floating cone



Sampling ball valve S4

Material:	PVC-U / PVDF
Seal material:	EPDM / FPM
Ball seating joint:	PTFE
Dimensions:	DN6
Operating pressure:	PN10
Accessories:	hose nozzle double nipple Blind plug



Sampling ball valve S4

Additional functions:



flap for lock
and metering ring



Locking ring for fixation „open“

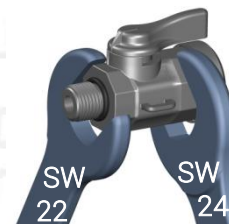

installation with SW22 or SW24



Fixation for plug

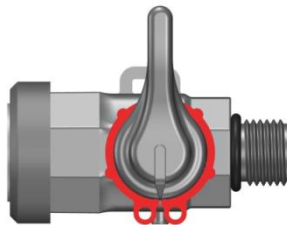

Locking ring for fixation „closed“
“



Metering marks

Butterfly valve K4

PRAHER
PLASTICS 

Materials

PVC-U, PVC-C, PP-H and PVDF

Seals

EPDM and FPM

Dimensions

DN65 - DN200

d50 - d225

2 ½" - 8"

Flange standards

DIN 2501 - PN10

ANSI - class 150

JIS 10 K (for DN200 with special solution)

BS Table D&E

Operating pressure

PN10

Operation

Handlever

Handgear

elektrical or pneumatical actuator



Assortment BFV K4

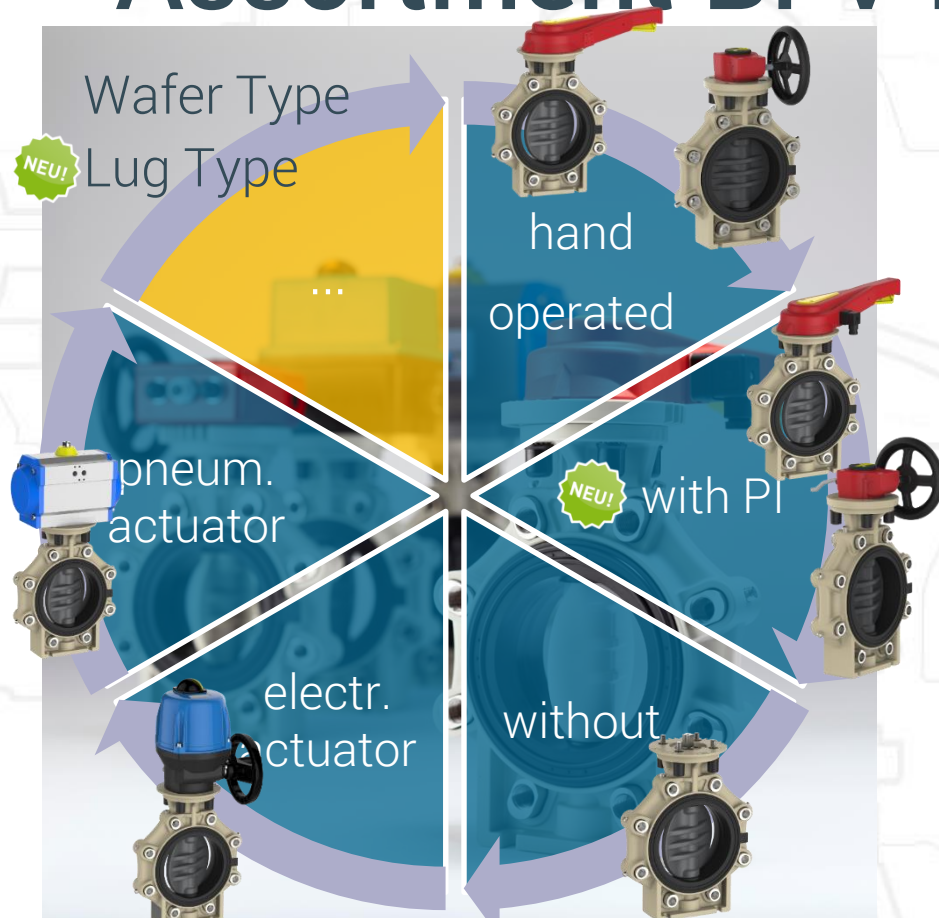

PVC-U DN65 - DN200



PVC-C DN65 - DN100



PP DN65 - DN200



PVDF DN65 - DN200

Butterfly valve K4 - PI



Handle - changed

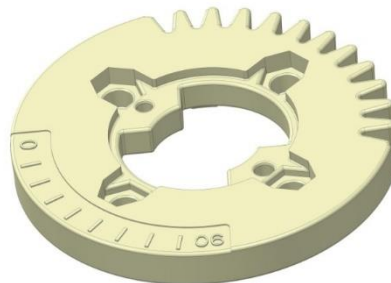
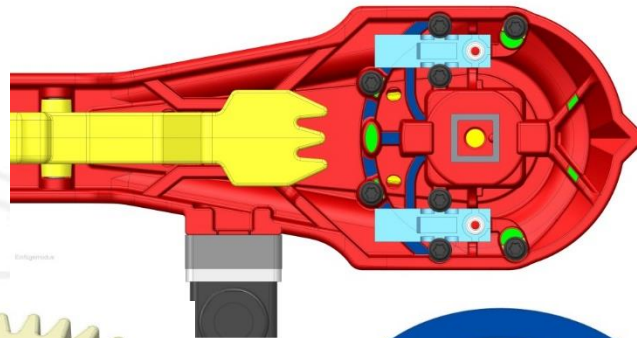

Cover plate - changed



Control plate - NEW

Butterfly valve K4 - PI

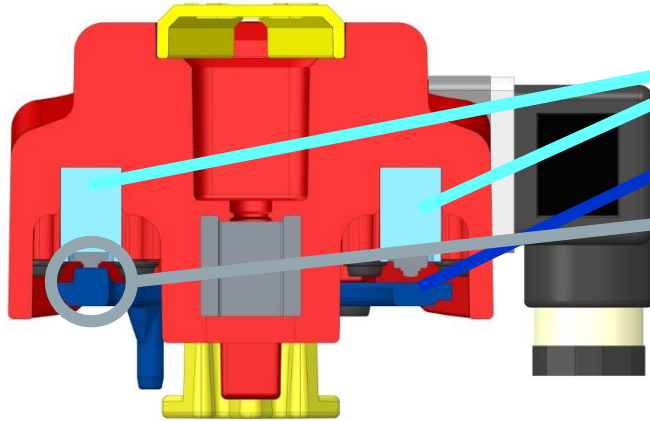

Function mode:

1. mech. Limit switch mounted in handle
2. Control plate additionally installed via Cover plate
3. Elevation at Control plate leads to actuation of limit switch
4. Feedback OPEN / CLOSED

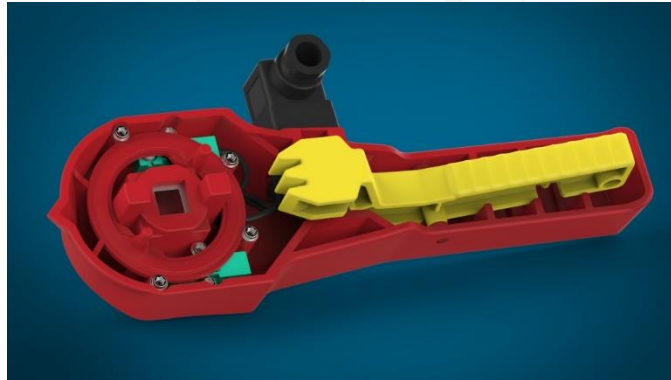
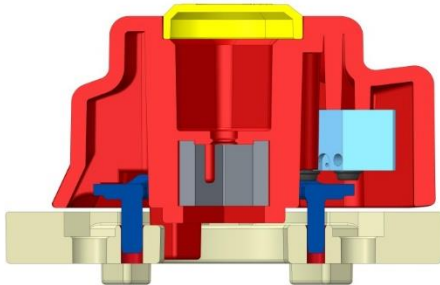

Butterfly valve K4 - Lug Type

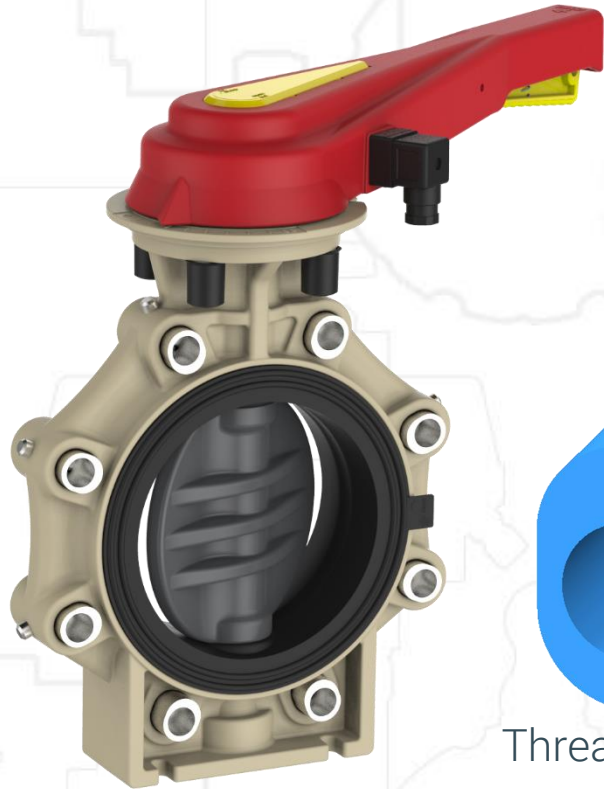

Thread insert - NEW



Dowel pin - NEW

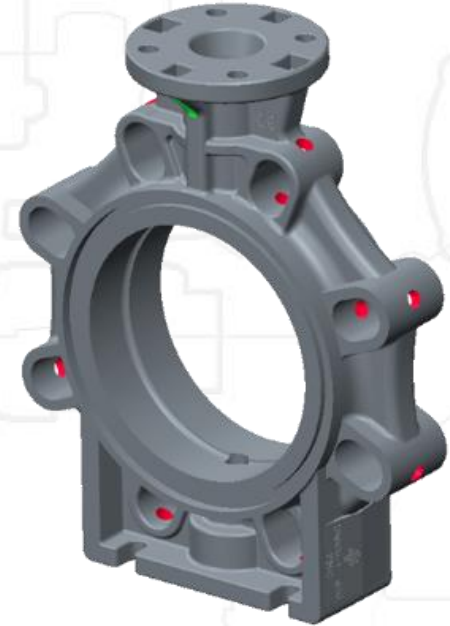

Body - machined

Diaphragm valve T4

Materials

PVC-U, PP-H and PVDF

Diaphragm

EPDM, FPM and PTFE-coated

Dimensions

DN15 - DN125

d20 - d140

½" - 5"

Connections

Spigot

Union / Socket

Flange

Operation

handwheel

direct pneum. actuated

pneum. actuator

Operating pressure

handwheel / pneum. actuator: PN10

direct pneum. actuated: PN6



Wafer check valve K6

Materials

PVC-U

Seals

EPDM and FPM (O-Rings)

Dimensions

DN40 - DN300

NEU!

d50 - d315

1 ½" - 12"

Flange standards

DIN 2501 - PN10

ANSI - class 150

Operating pressure

DN40 - DN200:

MOP10 bar

NEU!

DN250 / DN300:

MOP 8bar

Standard version

with spring mat. 1.4401 / AISI 316

Optional

without spring

with spring mat. Hastelloy C-4



Wafer check valve K4

Materials

PVC-U, PP, PP-GF and PVDF

Seals

EPDM and FPM (X-Rings)

Dimensions

DN65 - DN250

d75 - d280

2 ½" - 10"

Flange standards

DIN 2501 - PN10

ANSI - class 150

JIS - 10K

BS10 table E (only DN100 to DN250)

Operating pressure

PVC-U, PVDF: PN10

PP-GF: PN10 to DN200; PN8 = DN250

PP: PN6

optional

without spring



Comparison K6 and S4

K6



S4



MOP

10 or 8 bar

5-6 bar

Flow

+

o

Installation length

equal

Exit aid

optimized without

recommended

Spring

also upgradeable

not upgradeable

1.4401 (AISI316)

1.4571

+ Hastelloy

+ Hastelloy

Connections

DIN and ANSI

DIN

Dimensions

DN40 - DN300 

DN32 - DN300 (DN500)

Materials

PVC-U

PVC-U, PP-H and PVDF

Comparison K6 and K4

K6



K4



MOP

10 or 8 bar

Flow

+

Installation length

short

Exit aid

optimized without

Spring

also upgradeable

1.4401 (AISI316)

+ Hastelloy

PN10

++

long

integrated

Standard

no fluid contact

Connections

DIN and ANSI

Dimensions

DN40 - DN300 

Materials

PVC-U

DIN, ANSI, JIS, BS (DN100 to DN250)

DN32 - DN250

PVC-U, PP, PP-GF and PVDF

Comparison CV-values

each l/min
 $\Delta p = 1 \text{ bar}$



• DN65	867*	1.050	1.300
• DN80	1.517*	1.750	2.200
• DN100	2.067*	3.633	5.700
• DN150	6.583*	8.217	12.500
• DN200	15.533*	15.733	21.200
• DN250	25.000*	25.833	28.000

Measurements implemented as per EN 60534-2-3. Values at max. opening angle with PVC-U PN10 pipes and flow medium water at 20°C.

* to achieve the maximum opening angle special exit aids are necessary

Flowmeter M123 | M335 | M350

- PVC, PP
- Floats: PVDF or PVDF magnetic
- DN10 – DN65
- Measuring range: 1,5 – 60.000 l/h
- Double scale for water in percent and l/h
- Special adhesive scales for liquid and gaseous media



IBG® - Fittings

Standard Material: PVC-U
Standard color: PVC grey (special color black and white)
Operating Pressure: PN6 / PN10 / PN16
Dimensions: DN10 to DN300 (different per variant)
Standards: DIN / ASTM / JIS / BS (different per variant)

- **Straight connections**
Socket / hexagon nipple
on both sides, dimensionally constant connection element
- **Change of direction**
Elbow 45° / 90° Solvent
Elbow with male or female thread [also reinforced]
Pipe elbow 45° / 90° Solvent



IBG® - Fittings

- **Diameter change**
Reduction as short or long model
Solvent, female or male thread as connection transitions
- **Branch connection**
Tee / cross
45° / 90° / also as reduction, solvent and thread connection
- **Closing-off**
Cap / plug / blind flange
- **Connections to components**
FlexFit / Union / flange adapter in combination with flanges
- **Connection of various pipe materials**
Metal-plastic-union



IBG® - Fittings

Pipe Material: PVC-U
Standard Color: PVC grey (special color white and transparent)
Operating Pressure: PN6 / PN10 / PN16

Operating pressure depends on wall thickness (d x s), eg

d50 x 1,6 -> PN6

d50 x 2,4 -> PN10

d50 x 3,7 -> PN16

Dimensions: DN15 to DN300
Standard: DIN
Types: pipe with socket / without socket

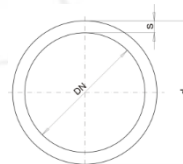

IBG® - Pipe Clips

for PVC – PP – PVDF and PE pipes

Material: PP black

Type A – pipe clip as clip version

Type B – pipe clip with closure plate
Only applicable for different pipe standards
(ASTM, DIN, JIS, ...)

Type C and D – pipe clip with closure bow

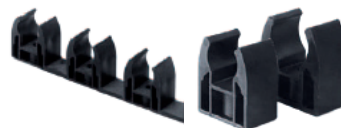

Typ A

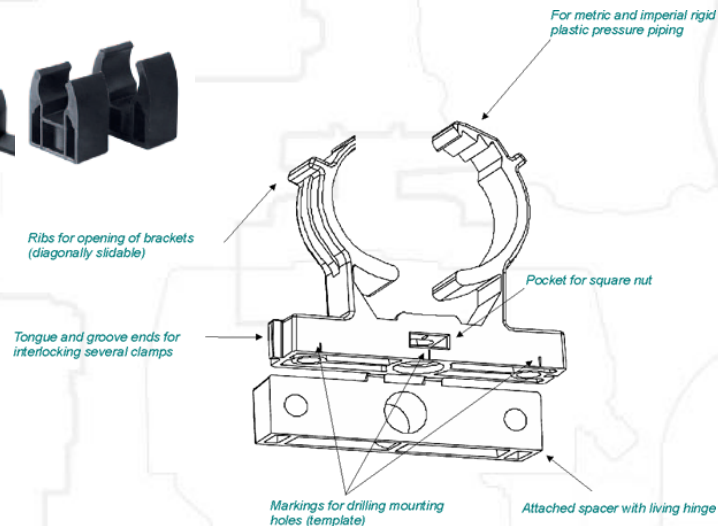

Typ C



Typ D

FlexFit® - General

Materials

PVC-U

Seals

EPDM

Dimensions

DN40 / DN50

Operating pressure

PVC-hose:
DN40 / DN50: PN4

NEU!

PE- pipe:
DN40: MOP8
DN50: MOP6

NEU!

PVC-pipe:
DN40: MOP8
DN50: MOP6

Pipe Connection

clamp - clamp
clamp - solvent socket
clamp - solvent spigot
clamp - male thread
clamp - female thread



Mounting PVC-U hose and PE pipe

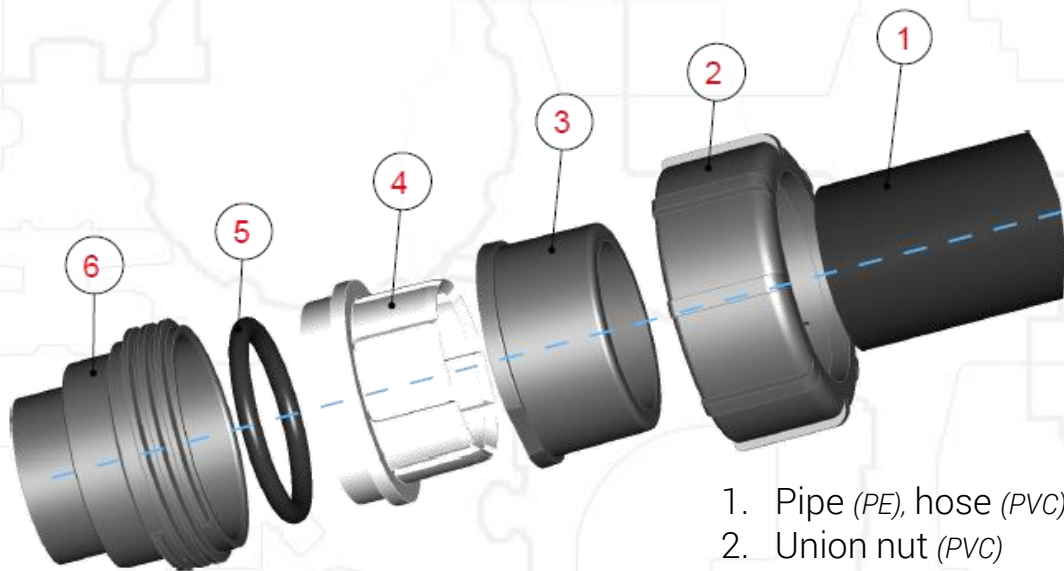





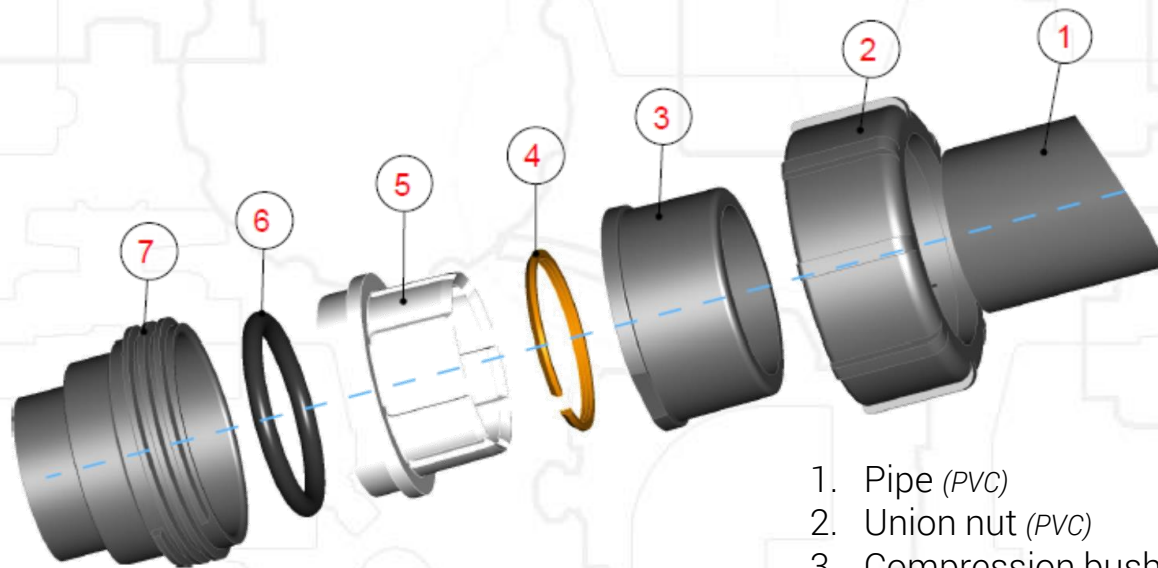



1. Pipe (PE), hose (PVC)
2. Union nut (PVC)
3. Compression bush (PVC)
4. Clamping ring (POM)
5. O-Ring (EPDM)
6. Adapter (PVC)

Mounting PVC-U pipe



1. Pipe (PVC)
2. Union nut (PVC)
3. Compression bush (PVC)
4. Brass ring (Messing)
5. Clamping ring (POM)
6. O-Ring (EPDM)
7. Adapter (PVC)

FlexFit® - detail

Definition:			Product description	PVC-hose		NEU! PE-pipe		NEU! PVC-pipe	
✓ available				DN40	DN50	DN40	DN50	DN40	DN50
- not necessary									
Finished parts	1.		Double Union	✓	✓	✓	✓	✓	✓
	2.		Adaptor Tee	✓	✓	✓	✓	✓	✓
	3.		Adaptor Union	✓	✓	✓	✓	✓	✓
	4.		Adaptor Elbow 45°	✓	✓	✓	✓	✓	✓
	5.		Adaptor Elbow 90°	✓	✓	✓	✓	✓	✓
	6.		Elbow	✓	✓	✓	✓	✓	✓
Equip- ment			Assembly Key	✓	✓	✓	✓	✓	✓
	NEU!		Brass Ring single packed	-	-	-	-	✓	✓

OEM

- Custom-made products according to individual wishes
- 50 years of experience
- Handshake quality and confidentiality



**Efficient
development**



**Advanced
mould making**



**High-quality
injection moulding**



**High-precision
mechanical machining**



**Correct, efficient
finishing**



**Support in logistics
and packaging**



**Total quality
management**



**High qualified
manpower**